



# Bandura, demountable

OWAlifetime collection

**OWA**

## System S 18d | Bandura, demountable

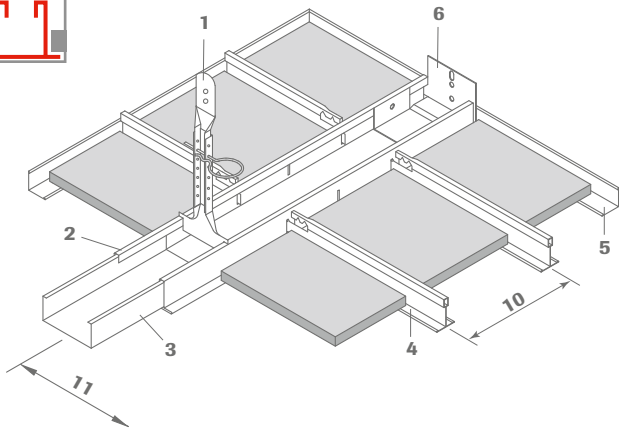

- 1 Nonius hanger no. 79/..., nonius hanger extension no. 16/... and safety pin no. 76
- 2 Bandraster profile no. 80/...GS, slotted on both sides
- 3 Connector no. 82/...G
- 4 Cross tee no. 47G/38 or no. 47G/38/4S
- 5 Wall angle no. 51/25 (edge 3)
- 6 Wall anchor no. 75/...G
- 7 Shadow wall angle no. 50/15 or no. 50/22 (edge 6)
- 8 Contura block no. 42/24 (edge 6)
- 9 Contura block no. 42/100 or no. 42/125 (edge 6)
- 10 Cross tee module size
- 11 Bandraster module size

### Cross-section:

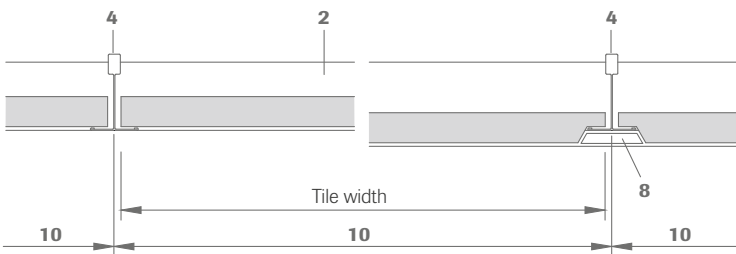

### Section dimensions:

No. 80/100GS or 80/125GS

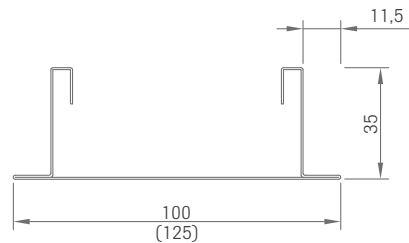

### Section:

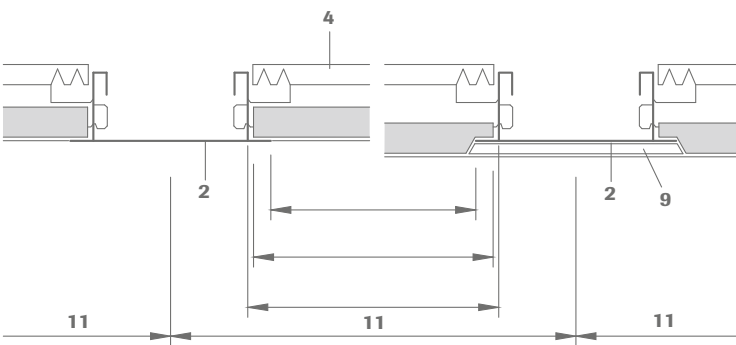

No. 47G/38 or no. 47G/38/4S

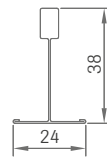

## Technical data | mineral tiles

### Dimensions/Designs

For possible dimensions and designs please refer to [OWAlifetime collection price list 9001 e.](#)

### Edge details



### Thickness

14 mm, 15 mm and 20 mm nom.

### Reaction to fire

A2-s1,d0 in accordance with EN 13501-1

### Metal suspensions

All metal components listed are galvanized steel or white coated galvanized steel respectively. For further details and colours please consult [OWAlifetime collection price list.](#)

### Suspension depth

100 mm (depending on the existing structural ceiling) for ease of panel removal 130 mm is recommended If the suspension depth is less than 150 mm the nonius hanger no. 79/... has to be shortenend on site.

## Wall perimeter:

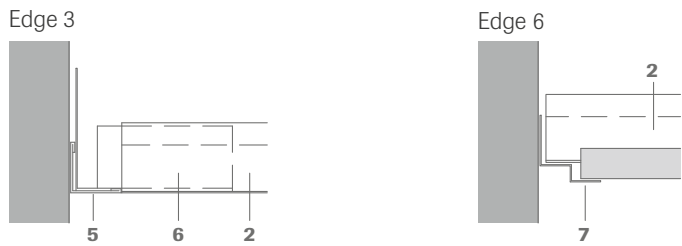

Other wall connection options and installation details can be found in [OWA-Installation Guide 9801 e](#).

## Installation examples:

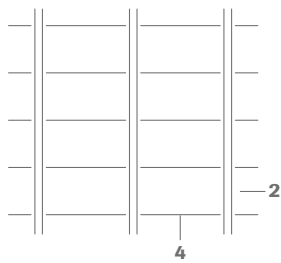

Module  $\leq$  1250 x 625 mm

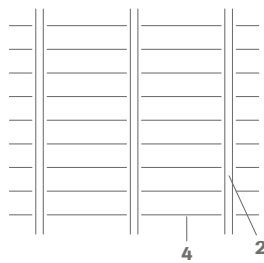

Module  $\leq$  2500 x 400 mm

## Section span widths for cross tees no. 47G/38/4S (with double-sided nose)

material thickness 0.4 mm

Cross tee module size	Span widths	
< 312.5 mm	2000 mm	Span widths for OWAacoustic premium tile 15 mm
< 400 mm	1900 mm	Span widths for OWAacoustic premium tile 15 mm
< 625 mm	1700 mm	Span widths for OWAacoustic premium tile 15 mm
< 312.5 mm	1900 mm	Span widths for OWAacoustic premium tile 20 mm
< 400 mm	1800 mm	Span widths for OWAacoustic premium tile 20 mm
< 625 mm	1600 mm	Span widths for OWAacoustic premium tile 20 mm

## Calculation note:

The precise panel sizes **between bandrafter sections** are calculated as follows:

- edge 3: clear dimension between the sections + 20 mm
- edge 6: clear dimension between the sections + 18 mm

The precise panel dimension **between cross tees** is calculated as follows:

spacing of the cross tees – 6 mm (in the case of edge 6 and edge 3 identical).

The precise length and order dimensions of the cross tees **no. 47G/38/4S** is calculated:

clear dimension between the bandrafter sections + 24 mm.

## Light fixtures:

OWA can supply compatible light fixtures for this system.

For details of performance, installation and fire resistance please see [OWA-brochure 9630 e](#) and [OWA-Installation Guide 9801 e](#).

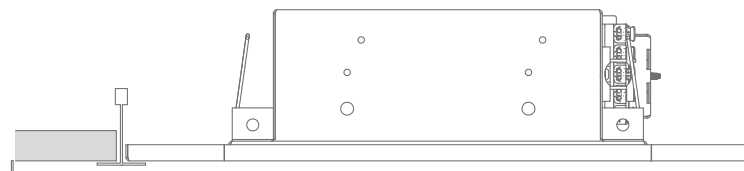

## Material requirements for bandraaster profiles per m<sup>2</sup>, visible side 100 mm (approximations):

No.	Description	Bandraaster module size					
		1200 mm	1250 mm	1800 mm <sup>°</sup>	2000 mm <sup>°</sup>	1276 mm*	1326 mm*
80/100GS	Bandraaster profile, slit	0.83 m	0.8 m	0.6 m	0.5 m	0.8 m	0.75 m
79/100	Nonius hanger	0.7 pce	0.7 pce	0.7 pce	0.7 pce	0.7 pce	0.7 pce
16/...	Nonius hanger extension	0.7 pce	0.7 pce	0.7 pce	0.7 pce	0.7 pce	0.7 pce
76	Safety pin	0.7 pce	0.7 pce	0.7 pce	0.7 pce	0.7 pce	0.7 pce
82/100G	Connector	0.3 pce	0.3 pce	0.2 pce	0.2 pce	0.2 pce	0.2 pce
51/25, 50/15	Wall angle	Quantity according to need, depending on room size and shape					
75/100G	Wall anchor	Quantity according to need, depending on room size and shape					
42/24	Contura block	Quantity according to need, depending on room size and shape					
42/100	Contura block	Quantity according to need, depending on room size and shape					

\* When using cross tee no. 47G/38, stock item

<sup>°</sup> Possible only when using edge 3!

No.	Description	Cross tee module size				
		300 mm	312.5 mm	400 mm	600 mm	625 mm
47G/38 or 47G/38/4S	Cross tee, 24 mm wide	3.3 m	3.2 m	2.5 m	1.7 m	1.6 m

### Weights:

Description	Weight
Cross tee no. 47G/38 or no. 47G/38/4S	0.363 kg/m
Bandraaster profile no. 80/100GS	1.034 kg/m
Tiles 15 mm, A2-s1,d0	4.5 kg/m <sup>2</sup>
Tiles 20 mm, A2-s1,d0	6.0 kg/m <sup>2</sup>

### System description:

#### OWAconstruct bandraaster system S 18d (Bandura)

#### Quality requirements for mineral tiles:

OWAacoustic mineral tiles firmly bound with a primer coat on both sides. The tile is free from asbestos. No formaldehyde is added in the manufacturing process of the mineral tiles. The mineral wool used for the manufacture of the tile is bio-soluble. The criteria for non-classification as a carcinogenic substance in accordance with the Chemicals Prohibition Ordinance (Section 1 Appendix, Paragraph 23 biopersistent fibres) are met and guaranteed by the ,RAL seal of approval for mineral wool'. Verification of fitness for use according to EU CPR: CE marking and Declaration of Performance (DoP).

Mineral tiles accordance with EN 13964 and DIN 18177:

Air permeability class	PM 1
Formaldehyde class	FH 1
Emission of VOC	TVOC 1

**Installation** should be carried out in accordance with the information contained in system leaflet S 18d and [OWA-Installation Guide 9801 e](#). All components are CE labelled.

#### Component list:

OWAconstruct nonius hanger no. 79/100 or no. 79/125  
 OWAconstruct Bandraaster profile no. 80/100GS or no. 80/125GS (module size max. 2500 mm)  
 OWAconstruct connector no. 82/100G or no. 82/125G  
 OWAconstruct cross tee no. 47G/38/4S (module size max. 625 mm, span widths max. 1250 - 2000 mm, depending on tile width. Suspend larger span widths additionally.)  
 OWAconstruct cross tee no. 47G/38 (length 1200 mm, 1250 mm)  
 OWAconstruct wall angle no. 51/25 or no. 50/15  
 OWAconstruct wall anchor no. 75/100G or no. 75/125G  
 OWAconstruct Contura block no. 42/24, no. 42/100 or no. 42/125



Certified Management Systems

### Product warranties

The information provided in this leaflet is based on the standards and data available at the time of publication. Any performance, warranties or guarantees provided, expressed or implied, are subject to the exclusive use of OWA components and the installation of those components in accordance with our recommendations. Failure to adhere to these conditions will result in the invalidation of any performance claims, warranties or guarantees and rejection of any liability. OWA reserves the right to make any technical improvements to the products, systems or services without prior notice. **All goods and services are supplied in accordance with our current Terms and Conditions of Sale.** Errors excepted!



The information in this brochure is up-to-date at the time of publication. Subject to alterations. Please contact our OWAconsult team for specific advice. Our experts will be happy to answer your questions using the following contact details:  
 tel: +49 9373 201-444 or e-mail: [info@owaconsult.de](mailto:info@owaconsult.de)

#### Odenwald Faserplattenwerk GmbH

Dr.-F.-A.-Freundt-Straße 3 | 63916 Amorbach | Germany  
 tel +49 9373 201-0 | [info@owa.de](mailto:info@owa.de)  
[www.owa-ceilings.com](http://www.owa-ceilings.com)