

Wide span beam profile type 6500

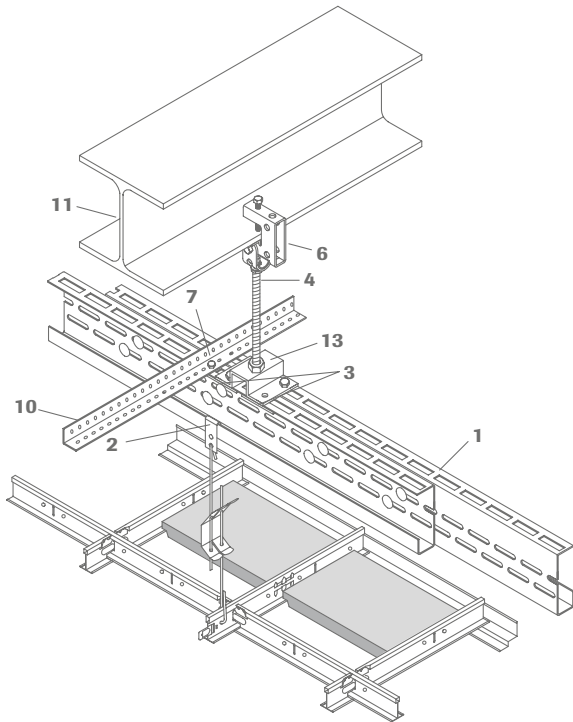

- 1 C wide-span profile no. 6500
- 2 Suspension clamp no. 6510
- 3 Ground plate no. 6520
(2 pieces per suspension, offset diagonally)
- 4 Threaded rod M10 onsite
- 5 Nut M10 and shim M10, onsite
- 6 Suspension clamp no. 6530
- 7 Self-tapping screw no. 6540
- 8 Mounting set no. 6550
- 9 Wall fixing angle no. 6560
- 10 Grid angle no. 6570
- 11 Steel support
- 12 Fixing materials based on static requirements and manufacturer's instructions
- 13 Adapter no. 6580 for hanging double supports
- 14 screw M 8 x 30 mm, nut M 8 and shim, onsite (2 per suspension, offset diagonally)

Wide span beam profile for OWAacoustic® ceilings systems

It is not always possible to suspend OWA ceiling systems directly from the existing unfinished ceiling or roof structure. When existing structures cannot bear any additional weight from a suspended ceiling, or spans that are too large to be bridged with standard versions of the OWA ceiling systems, OWAconstruct® wide span profiles can be used. In addition to the exposed OWAconstruct® System Type 8550 (see brochure no. 9608 e), our wide span profiles, system type 6500, can be used in such areas.

Wide span beam profile no. 6500:

Depending on the grid spacing of the wide span profiles and the weight of the suspended ceiling, spans of up to 7.7 m can be realized.

Delivery lengths:

4000 mm, 6000 mm (other lengths on request)

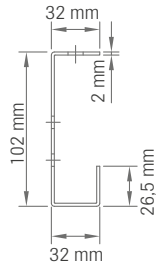

Wall perimeter:

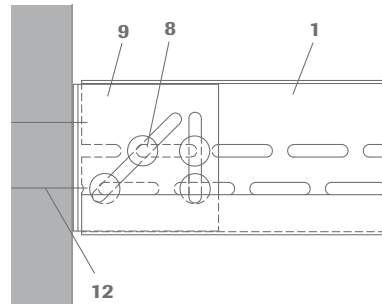

Installation of a continuous profile:

The profiles must overlap back to back at least 500 mm and must be suspended within this range.

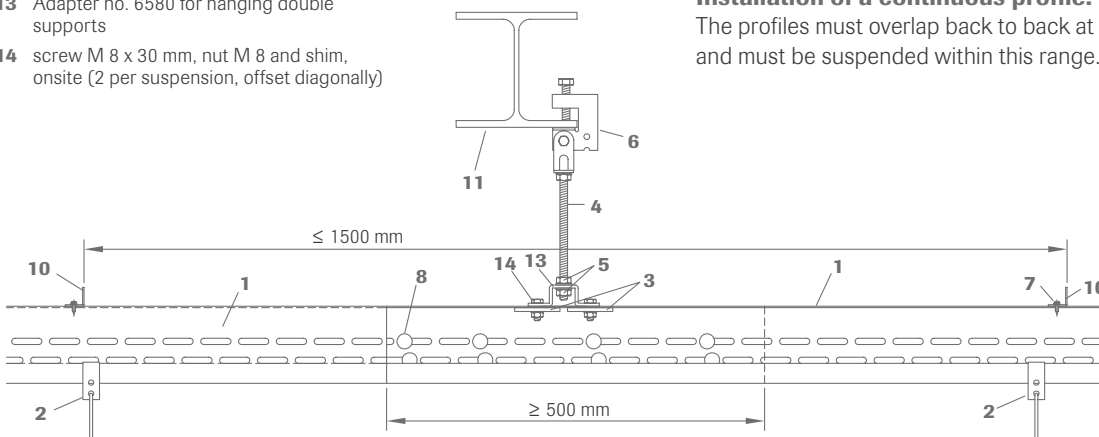

Wide span beam profile type 6500

Double profile screw coupling:

screw fastened offset with the installation set no. 6550 every 500 mm. No piecing together permitted.

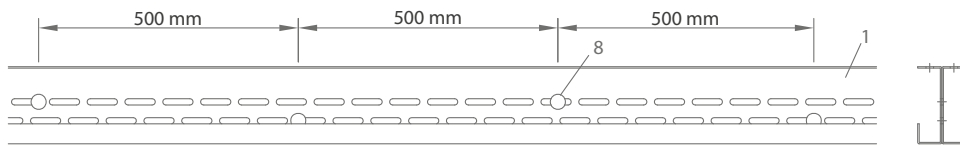

Span Table - Wide Span Profiles 6500:

Sagging $l/300$

Load: 0.10 kN/m^2

OWA ceiling to 0.08 kN/m^2 and additional load $\leq 0.02 \text{ kN/m}^2$

Module distance C-wide span beam profiles	Span]] C-6500 single	Bearing load (Profile on two carriers)	Span]] 6500 double	Bearing load
750 mm	6310 mm	0.32 kN	7380 mm	0.46 kN
1000 mm	5860 mm	0.37 kN	6940 mm	0.52 kN
1250 mm	5510 mm	0.41 kN	6600 mm	0.58 kN

Load: 0.08 kN/m^2

OWA ceiling to 0.08 kN/m^2 without additional load

Module distance C-wide span beam profiles	Span]] C-6500 single	Bearing load (Profile on two carriers)	Span]] 6500 double	Bearing load
750 mm	6660 mm	0.28 kN	7700 mm	0.42 kN
1000 mm	6210 mm	0.33 kN	7280 mm	0.47 kN
1250 mm	5860 mm	0.37 kN	6940 mm	0.52 kN

In the case of unequal spans of adjacent fields of continuous profiles, the ratio of large to small span must not be greater than two.

Example:

Span field 1: 3000 mm, span field 2: 5000 mm → **permissible** (ratio less than two)

Span field 1: 3000 mm, span field 2: 6100 mm → **not permissible** (ratio greater than two)

For design details and information, refer to OWA installation guide no. 9801 e.

For technical questions or fire protection requirements, please contact our OWAconsult® team.

Product Warranties

The information provided in this leaflet is based on the standards and data available at the time of publication. Any performance, warranties or guarantees provided, expressed or implied, are subject to the exclusive use of OWA components and the installation of those components in accordance with our recommendations. Failure to adhere to these conditions will result in the invalidation of any performance claims, warranties or guarantees and rejection of any liability. OWA reserves the right to make any technical improvements to the products, systems or services without prior notice. **All goods and services are supplied in accordance with our current Terms and Conditions of Sale.** Errors excepted!



OWA

Odenwald Faserplattenwerk GmbH

Dr.-F.-A.-Freundt-Straße 3 | 63916 Amorbach | Germany

tel +49 93 73.2 01-0 | info@owa.de

www.owa-ceilings.com

Brochure 9607 e
021700